

COBRA

MODEL: MX51S80V (DYM192404)

COBRA LAWN MOWER OWNER'S MANUAL



WARNING!

When using the machine the safety rules must be followed. For your own safety and bystanders please read these instructions before operating the machine. Please keep the instructions safe for later use.

Cobra Garden Machinery

Henton and Chattell Ltd., London Road, Nottingham NG2 3HW UK

www.cobragarden.co.uk

CONTENT

SECTION 1 SYMBOLS MARKED ON THE PRODUCT	3
SECTION 2 GENERAL SAFETY RULES.....	6
SECTION 3 GENERAL IDENTIFICATION	15
SECTION 4 TECHNICAL DATA	16
SECTION 5 ASSEMBLY	16
SECTION 6 ADJUSTMENT OF CUTTING HEIGHT	19
SECTION 7 "3 IN 1"	20
SECTION 8 SAFETY PRECAUTIONS	21
SECTION 9 STARTING.....	22
SECTION 10 BLADE.....	24
SECTION 11 MAINTENANCE AND CARE.....	25
SECTION 12 TROUBLESHOOTING.....	26
SECTION 13 ENVIRONMENTALLY FRIENDLY DISPOSAL	26
SECTION 14 WARRANTY.....	27
SECTION 15 EC-DECLARATION OF CONFORMITY	28

KNOW YOUR LAWN MOWER

Read this manual carefully, observing the recommended safety instructions before, during and after using your lawn mower. Following these simple instructions will also maintain your lawn mower in good working order. Familiarize yourself with the controls on your mower before attempting to operate it, but above all, be sure you know how to stop your mower in an emergency. Retain this user manual and all other literature with your mower for future reference.

1. SYMBOLS MARKED ON THE PRODUCT



Read this instruction book carefully before using the lawn mower and keep it in a safe place for future reference.



Keep bystanders away.



Beware of sharp blades. Blades continue to rotate after the motor is switched off.



Switch off isolator key before adjusting, cleaning and before leaving the product unattended for any period.



The charger is intended for indoor use only.



Wear hearing and eye protection

IPX4

The machine is protected against ingress of water drop from vertical direction



Do not expose to rain or damp conditions.



Do not operate on inclines greater than 15°. Mow across the face of slopes, never up and down.



Electric shock hazard.



Wait until all machine components have completely stopped before touching them.



CE Marking

The product meets demands and regulations set by the European Community.



WEEE Marking

CAUTION! Unusable power tools do not belong with domestic waste. They must be taken to a communal collecting point for environmentally friendly disposal in accordance with local regulations.



Battery Disposal:

Old accumulators and batteries must not be added to household waste, but should be disposed of in accordance with the applicable legislation.

- Take unusable rechargeable batteries to the dealer's or community's battery collection point.

Disposing of the packaging:

The packaging is made of cardboard and separately labeled foil which is also recyclable.

- Take these materials to a recycling centre.

Disposing of the packaging:

The packaging is made of cardboard and separately labeled foil which is also recyclable.

- Take these materials to a recycling centre.



Li-Ion

Battery packs/batteries: Li-Ion

Do not dispose of batteries into household waste, water or fire. Battery packs/batteries must be collected, recycled or disposed of in an environmentally -friendly way.

Defective or dead batteries must be recycled according to the directive 2006/66/EC



Noise level marking.

Your tool noise is not more than 92dB.

▲ SAFETY ALERT SYMBOL:

Indicates caution or warning may be used in conjunction with other symbols or pictures.

2. GENERAL SAFETY RULES

The purpose of the safety rules is to attract your attention to possible dangers. The safety symbols and the explanations with them, require your careful attention and understanding.

The safety warnings do not by themselves eliminate any danger. The instruction or warnings they give are not a substitutes for proper accident prevention measures.

▲WARNING: Failure to follow a safety warning can result in serious injury to yourself or to others. Always follow the safety

precautions to reduce the risk of fire, electric shock and personal injury. Save the owners manual and review frequently for continuing safe operation and instructing others who may use this tool.

▲WARNING: This machine produces an electromagnetic field during operation. This field may under some circumstances interfere with active or passive medical implants. To reduce the risk of serious or fatal injury, we recommend persons with medical implants to consult their physician and the medical implant manufacturer before operating this machine.

▲ WARNING: The operation of any tool can result in foreign objects being thrown into your eyes, which can result in eyes being severely damaged. Before beginning power tool operations, always wear safety goggles or safety glasses with side shields and a full face shield when needed. We recommend wide vision safety masks for use over eyeglasses or standard safety glasses with side shield.

IMPORTANT

READ CAREFULLY BEFORE USE.

KEEP FOR FUTURE REFERENCE.

1) Read the instructions carefully. Be familiar with the controls

and the proper use of the equipment.

- 2) Never allow children or people unfamiliar with these instructions to use the lawnmower. Local regulations can restrict the age of the operator
- 3) Never mow while people, especially children, or pets are nearby.
- 4) Keep in mind that the operator or user is responsible for accidents or hazards occurring to other people or their property.
- 5) While mowing, always wear substantial footwear and long trousers. Do not operate the equipment when barefoot or wearing open sandals; Avoid wearing clothing that is loose fitting or that has hanging cords or ties.
- 6) Thoroughly inspect the area where the equipment is to be used and remove all objects which can be thrown by the machine.
- 7) Before using, always visually inspect to see that the blades, blade bolts and cutter assembly are not worn or damaged. Replace worn or damaged blades and bolts in sets to preserve balance. Replace damaged or unreadable labels.
- 9) Mow only in daylight or in good artificial light.
- 10) Avoid operating the equipment in wet grass, where feasible.
- 11) Always be sure of your footing on slopes.
- 12) Walk, never run.

13) For rotary mowers; mow across the face of slopes, never up and down.

- 14) Exercise extreme caution when changing direction on slopes.
- 15) Do not mow excessively steep slopes.
- 16) Use extreme caution when reversing or pulling the lawnmower towards you.
- 17) Stop the blades if the lawn mower has to be tilted for transportation when crossing surfaces other than grass, and when transporting the lawn mower to and from the area to be mowed.
- 18) Never operate the lawnmower with defective guards, or without safety devices, for example deflectors and/or grass catchers, in place.
- 19) Start or switch on the motor carefully according to instructions and with feet well away from the blades.
- 20) Do not tilt the lawnmower when starting switching on the motor, except if the lawnmower has to be tilted for starting. In this case, do not tilt it more than absolutely necessary and lift only the part which is away from the operator.
- 21) Do not start the motor when standing in front of the discharge chute.
- 22) Do not put hands or feet near or under rotating parts. Keep

clear of the discharge opening at all times.

23) Never pick up or carry a lawnmower while the motor is running.

24) Stop the motor and switch off the isolator key. Make sure that all moving parts have come to a complete stop.

- whenever you leave the machine
- before clearing blockages or unclogging chute
- before checking, cleaning or working on the lawnmower
- after striking a foreign object. Inspect the lawnmower for damage and make repairs before restarting and operating the lawnmower

If the lawnmower starts to vibrate abnormally (check immediately)

- inspect for damage
- replace or repair any damage parts.
- check for and tighten any loose parts.

25) Stop the mower, whenever you leave the lawnmower

26) Keep all nuts, bolts and screws tight to be sure the equipment is in safe working condition.

27) Check the grass catcher frequently for wear or deterioration.

28) Replace worn or damaged parts for safety.

29) Children are not allowed to use the machine.

30) This appliance is not intended for use by persons with reduced physical, sensory or mental capabilities, or lack of experience and knowledge, unless they have been given supervision or instruction concerning use of the appliance by a person responsible for their safety.

31) Be careful during adjustment of the machine to prevent entrapment of the fingers between moving blades and fixed parts of the machine.

32) Always allow the machine to cool before storing.

33) After use and before storage, remove the battery from the machine and check for damage.

34) When servicing the blades be aware that, even though the power source is switched off, the blades can still be moving.

35) Replace worn or damaged parts for safety; Use only genuine replacement parts and accessories.

37) Recharge only with the charger specified by the manufacturer. Using a charge with an incompatible battery pack may create a risk of fire.

38) Use power tools only with specifically designated battery packs. Use of any other battery packs may create a risk of injury and fire.

39) When the battery pack is not in use, keep it away from other metal objects like, paper clips, coin, keys, nails, screws, or

other small metal objects, that can make a connection from one terminal to another. Shorting the battery terminals together may cause burns or a fire.

40) If the battery is damaged, liquid may be ejected from the battery:

- If contact accidentally occurs, flush with water.
- If liquid contacts eyes seek medical help immediately. Liquid ejected from the battery may cause irritation or burns.

Safety Advice for Rechargeable Battery and Charger

Use only the battery provided with the lawn mower and the provided charger.

Protect the battery and the battery charger from humidity and damp conditions.

Do not operate the battery charger outdoors.

When it is not in use or before cleaning and servicing, disconnect the battery charger from the power supply.

Take special care of the battery. Avoid dropping it onto any hard surface and do not subject it to pressure or any other form of mechanical stress. Keep the battery away from extreme heat and cold.

Do not open or attempt to repair the battery or the battery

charger. If any parts are defective, have them repaired by a qualified technician or send them to our service department for repair.

Only charge the battery at an ambient (surrounding air) temperature between 0°C and +40°C.

A charged battery can be used to power the machine under ambient temperature conditions between -20 °C and +40 °C.

When not in use, store the battery in a dry place between 10°C and 30°C.

Recharge the battery as soon as the mower's performance starts to decline. DO NOT CONTINUE using product with its battery in a depleted condition. **The battery is not fully charged at the factory.** Before attempting to use it, it must be fully charged firstly.

⚠ Important! Danger!

Never short-circuit the battery or expose it to moisture. Do not store it together with any metal parts which could short-circuit the contacts. The battery could overheat, start burning or explode. If any person comes into contact with acid or similar internal fluids or substances contained in the battery, wash off these substances immediately with plenty of water. If these substances make contact with the eyes, rinse with plenty of

water and visit a doctor immediately.

⚠ WARNING!

Do not dismantle the battery pack to remove the battery cells. Do not place the rechargeable battery into fire or water. It can explode. The rechargeable battery should not be discarded to domestic refuse, regardless of whether used or unused. You should return it to a local battery collection point in accordance with Battery Regulations or return them to us suitably marked “Used Battery”.

3. GENERAL IDENTIFICATION



Fig.1

- | | | | |
|----------------------------|-------------------------------|--------------------|-------------------|
| 1. Switch button | 2. Safety push-button | 3. Switch box | 4. Cable clamp |
| 5. Grass catcher | 6. Height adjusting lever | 7. Wheel | 8. Sideward flap |
| 9. Battery door | 10. Rear cover | 11. Lower handle | 12. Locking lever |
| 13. Upper handle | 14. Self-drive control handle | 15. LED display | |
| 16. Side discharge channel | | 17. Mulching wedge | |

4. TECHNICAL DATA

Model:	MX51S80V (DYM192404)
Rated Voltage:	80V DC
No Load Speed:	2800min ⁻¹
Grass Catcher Capacity	60L
Cutting Width:	510mm
Net Weight:	29.3kg
Height Adjustment :	25-75mm,7adjustment

	MX51S80V (DYM192404)
Sound Pressure Level at The Operator's Position	77.6dB(A) K=3 dB(A)
Measured Sound Power Level	88.5dB(A) K=0.62dB(A)
Guaranteed Sound Power Level	92dB(A)
Vibration	1.04m/s ² K=1.5 m/s ²

Battery	Lithium-ion
Model Number	Twin Battery - DYMA104
Rated Voltage	40Vd.c.each
Capacity	5.0AH/180Wh each
Number of Battery	20pcs
Battery Charger	
Model Number	DYMA85
Input	220-240V a.c.,50Hz, 2A
Output	40V d.c.,4A
Allowable Charging Temperature Range	0-45°C

5. ASSEMBLY

5.1 ASSEMBLY THE FOLDING HANDLE

1. Fix the lower handlebars into the mower body with pipe sleeve, sleeve bushing, bolts and locking knobs. (Fig. 2A/ Fig.2B)
2. Lift the two locking levers to release the upper handlebars for folding. (Fig. 2C)
3. Push the locking lever closed to lock the handlebars in the operating position. (Fig. 2D)
4. Adjust the tension by turning the lock nut with a suitable spanner. (Fig. 2E)
5. Attach the cable to the cable clamp and then attach the cable clamp to the position shown. (Fig.2F)

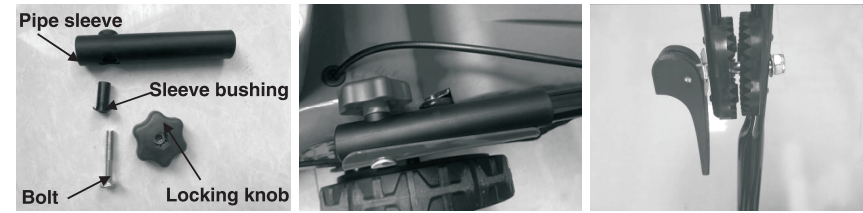

Fig. 2A

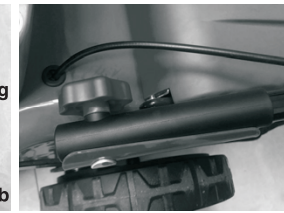

Fig. 2B



Fig. 2C

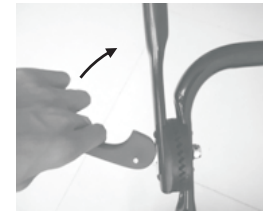

Fig. 2D

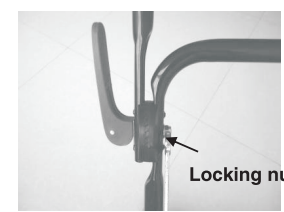

Fig. 2E

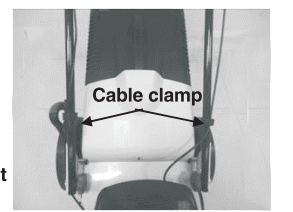

Fig.2F

5.2 ADJUSTMENT FOR THE OPERATOR HEIGHT

1. Pull the locking lever open.
2. Rotate the upper handle, centered on the angle adjusting gear. Select the angle required for the operator height. A number of selections are available between -20° to 20° as the Fig.3 shows;
3. Push the locking lever closed to connect the lower handle and the upper handle. Ensure this firmly locates and locks.

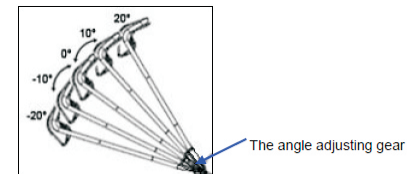

Fig. 3

5.3 ASSEMBLE THE GRASS CATCHER

Assemble the handle onto the grass catcher (Fig.4A/ Fig.4B/ Fig.4C)

Insert the end with a projection into the grass catcher, and then fix another end of the handle onto the grass catcher with the screw provided.

1. To fit: Raise the rear cover and hitch the grass catcher on the rear of the mower. (Fig.4D/ Fig.4E/ Fig.4F)
2. To remove: grasp and lift the rear cover, remove grass catcher.

There is a grass level indicator on the top of the grass catcher that shows if the catcher is full:

- The level indicator is blown up if the catcher is not full during the mowing. (Fig. 4G)
- If the catcher is full, the indicator is flush with the cover; once this happens stop mowing immediately and empty the catcher, make sure it is clean and ensure its meshwork is clear. (Fig. 4H)

! IMPORTANT:

If the bag full indicator vents are blocked, the indicator will not rise -in this case, clean the indicator opening immediately.



Fig.4A



Fig.4B



Fig.4C



Fig.4D



Fig.4E

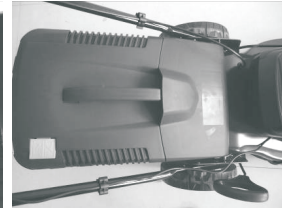

Fig.4F

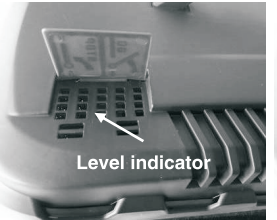

Fig.4G



Fig.4H

5.4 FIT THE ISOLATOR KEY

1. Open the battery door. (Fig.5A/ Fig.5B)
2. Insert the isolator key into the slot. (Fig. 5C)



Fig.5A



Fig.5B

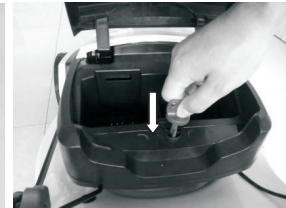

Fig.5C

5.5 INSTALLING THE BATTERIES

1. Open the battery door.
2. Make sure the isolator key is switched off. Switch mark "1" is ON, "0" is "OFF". (Fig. 6A)
3. Insert the two battery packs into battery holder. (Fig. 6B/Fig.6C)
4. Make sure the latch on bottom of the battery pack snaps in place and that battery pack is fully seated. (Fig. 6C)
5. Close the battery door. (Fig.6D)



Fig.6A



Fig. 6B

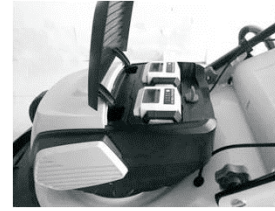

Fig. 6C



Fig.6D

5.6 TO REMOVE THE BATTERY

1. Open and hold open the battery door.
2. Press and hold the battery latch button at the bottom of the battery pack. (Fig.7A)
3. Remove the battery pack from the product. (Fig.7B)



Fig.7A

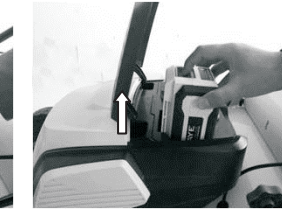

Fig.7B

6. ADJUSTMENT OF THE CUTTING HEIGHT

Apply outward pressure to disengage the lever from rack. Move the lever forward or back to adjust height. The height (the blade to the ground) can be adjusted from 25mm to 75mm, with 7 height positions.



Fig.8

⚠ WARNING: Make this adjustment only when the blade is stopped.

⚠ WARNING: Make sure the isolator key is switch off.

7. “3 IN 1” FUNCTION

The lawn mower can be configured from its normal rear grass collecting function as follows:

1. Mulching mower or as.
2. Side-discharge mower.

Understanding mulching as an alternative to grass collection:

When mulching, the grass is cut in one working step, then finely chopped and returned to the grass strip as natural fertilizer. The cutting method results in the grass being cut multiple times.

Hints for mulch-mowing:

- Regularly cut to a maximum of 2 cm from 6 cm to 4cm grass height.
- Ensure the cutting blades are sharp - Do not mow wet grass.
- Only mow at a normal walking pace.
- Regularly clean the mulching wedge, housing inner side and mowing blade. Always remove the batteries first.

Starting Operation

ONE: Configuring for mulching mowing

⚠ WARNING: Only proceed once the blade has fully stopped. Remove the batteries.

1. Raise the rear cover and remove the grass catcher.
2. Push the mulching wedge into the deck. Lock the mulching wedge with the button into the opening on the deck. (Fig 9A/ Fig 9B)
3. Lower the rear cover again. (Fig 9C)
4. Lift the sideward flap and remove the side discharge channel, where fitted.

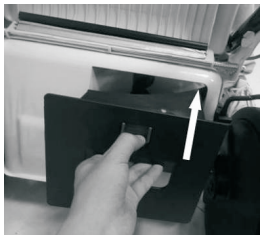

Fig. 9A



Fig. 9B



Fig 9C

TWO: Configuring for side-discharge mowing

⚠ WARNING: Only proceed once the blade has fully stopped. Remove the batteries.

1. Lift the rear cover and remove the grass catcher.
2. Fit the mulching wedge.
3. Lift the sideward flap for side discharge mowing. (Fig.9D)
4. Mount the side discharge channel for side discharge on the support pin of the sideward flap. (Fig.9E)
5. Lower the sideward flap- the flap lies on the side discharge channel. (Fig 9F)

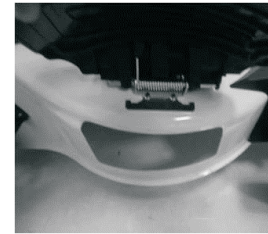

Fig. 9D



Fig. 9E



Fig.9F

THREE: Mowing with the grass catcher

⚠ WARNING: Only proceed once the blade has fully stopped. Remove the batteries.

For mowing with the grass catcher, remove the mulching wedge and discharge channel for side discharge and mount the grass catcher.

1. Removing the mulching wedge:

-Lift the rear cover and remove the mulching wedge.

2. Removing the side discharge channel:

-Lift the sideward flap and remove the side discharge channel.

-The sideward flap automatically closes the discharge opening on the housing with a spring force.

-Regularly clean the sideward flap and discharge opening where grass clippings may collect.

3. Fit the grass catcher:

-To fit: Raise the rear cover and hitch the grass catcher on rear of mower.

-To remove: Grasp and lift the rear cover, remove grass catcher

8. SAFETY PRECAUTIONS

- a) Always operate with the deflector or grass catcher in the correct position.
- b) Always stop the motor before removing the grass catcher or adjusting the height of cut position.
- c) Before mowing, check and clear any debris, stones or objects from the lawn which may be thrown by the machine. While mowing, stay alert for any objects which may have been missed. (Fig.10A)
- d) Never lift the rear of the mower while starting the motor or during normal operation. (Fig.10B)
- e) Never place your hands or feet underneath the under pan of the mower or into the rear discharge chute while the motor is running. Fig.10C. **Remove the batteries before completing any maintenance.**

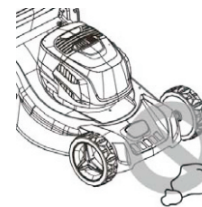

Fig.10A

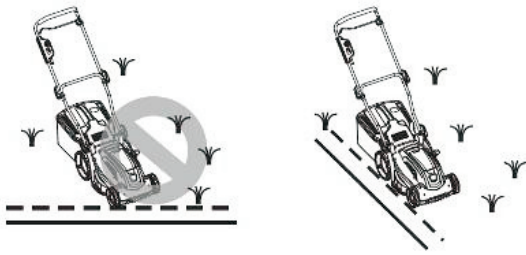

Fig.10B

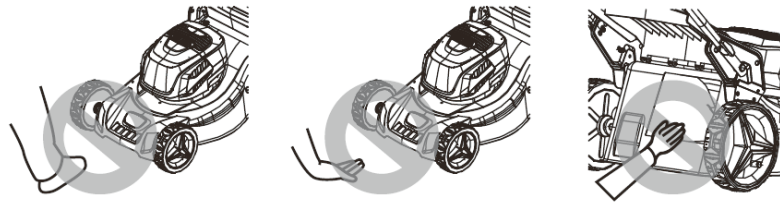

Fig.10C

9. OPERATING INSTRUCTIONS

9.1. STARTING

Switch on the isolator key

Start the motor as follows

1. Press the safety push-button (1).
2. Whilst engaging the safety push button, press any of the handle switch buttons (There are four buttons) (2), and keep it depressed. Release the initial switch (1), but continue to engage one of the four handle buttons(2)

Lift the front of the machine and switch off the isolator key while crossing gravel or roads surface.

If you release switch button (2) depressed, the motor will stop. (Fig.11)

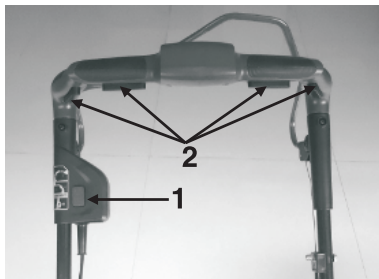

Fig.11

9.2 OPERATING THE POWER DRIVE

Grip the self-drive control handle, the lawnmower will move forward automatically at about 3.6km/h.

Release the self-drive handle, the lawnmower will stop moving.

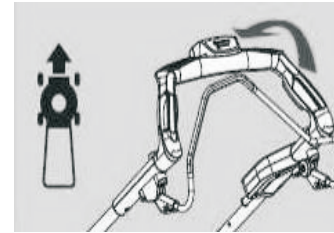

Fig.12

! CAUTION: your mower is designed to cut normal residential grass of a height no more than 250mm.

Do not attempt to mow through unusually tall dry or wet grass (e.g. pasture) or piles of dry leaves. Debris may build up on and around the mower deck, always keep this clear.

9.3 LED BATTERY INDICATORS

Please refer to the following table for the meaning of LED display.

Lawn mower status	Battery pack capacity indicator status (Press "POWER" button(1))	Abnormal situation indicator status
	Green light(2)	Red light (3)
The battery pack capacity is between 75%~100%.	Four LEDs ON	N/A
The battery pack capacity is between 50%~75%.	Three LEDs ON	N/A
The battery pack capacity is between 25%~50%.	Two LEDs ON	N/A
The battery pack capacity is between 0%~25%.	One LED ON	N/A
Motor blocked	N/A	ON
The battery pack is low voltage	N/A	Flashing twice
Overheating motor controller	N/A	Frequently flashing

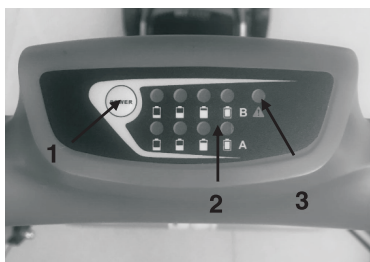

Fig.13

9.4 FOR THE BEST RESULTS WHEN MOWING

Clear the lawn of debris. Be sure that the lawn is clear of stones, sticks, wire or other foreign objects, which could be accidentally be thrown out by the mower in any direction and cause serious personal injury to the operator and others as well as damage to property and surrounding objects.

Do not cut wet grass. For effective mowing do not cut wet grass, because it tends to stick to the underside of the deck preventing proper collection of the grass clippings. Cut no more than 1/3 the length of the grass. The recommended cut for mowing is 1/3 the length of the grass. Ground speed will need to be adjusted, so the clippings can be dispersed evenly into the lawn.

When mowing long grass you may have to cut the lawn in two passes, lowering the blade another 1/3 of the length for the second cut and perhaps cutting in a different pattern than was used the first time. Overlapping the cut a little on each pass will also help to clean up any stray clippings left on the lawn. Clean the underside of deck. Be certain to clean the underside of the cutting deck after each use to avoid a build-up of grass, which would prevent proper cutting. Always remove the starter isolator before cleaning. Mowing leaves. The mowing of leaves can also be beneficial to your lawn. When mowing leaves make sure they are dry and are not laying too thick on the lawn. Do not wait for all the leaves to be off the trees before you mow.

WARNING: if you strike a foreign object, stop the motor. Switch off the isolator key, thoroughly inspect the mower for any damage and repair the damage before restarting and operating the mower. Extensive vibration of the mower during operation is an indication of damage. The unit should be promptly inspected and repaired.

10. BLADE

The blade is made of pressed steel. It will be necessary to sharpen or replace to ensure the optimum performance of the mower. Ensure that it is always balanced (an unbalanced blade will cause dangerous vibrations). It is recommend to have your lawnmower serviced annually and have the blade replaced.

If the blade is removed and replaced, refit making sure that the cutting edges face in the direction of the motor rotation. The blade bolt (2) must be torqued to 20N.m.

! WARNING: For service, replace the blade with **Cobra blade: Cobra 2105300084**

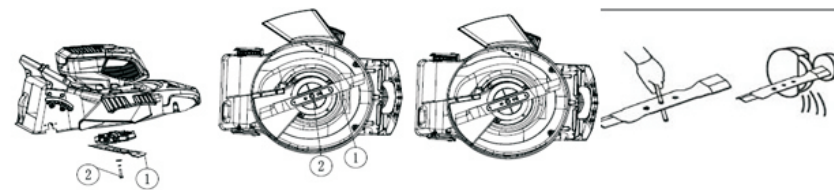

Fig.14

! WARNING: Remove the battery from the machine.

! WARNING: Protect your hands by using heavy duty gloves or a rag to grasp the cutting blades when replacing the blade.

11. MAINTENANCE AND CARE

! Warning: Before performing any Maintenance or cleaning work, Always remove batteries and switch off the isolator key!

Do not spray the unit with water. Ingress of water may damage the switch-plug combination unit and the electric motor. Clean the unit with a cloth or soft hand brush.

Expert inspection is required in the following circumstances:

- if the lawn mower strikes an object.
- if the motor stops suddenly
- if the blade is bent (do not align!)
- if the motor shaft is bent (do not align!)
- If the V-belt is defective.
- Use only manufacturer's recommended replacement parts and accessories.

Contact your local dealer for assistance. Do not make any adjustment yourself.

12. TROUBLESHOOTING

Problem	Possible cause	Possible solution
Motor does not run	Power Turn off	Turn the power on
	Grass too long	Increase the height of cut and move the mower to shorter grass to start
	Blade is blocked	Remove the obstacle – remove batteries first
Motor power drops	Blade is blocked	Remove the obstacle – remove batteries first
	Blade is blunt or damaged	Replace or sharpen the blade
Grass catcher is not filled	Grass is too short	Correct the cutting height
	Grass is too wet	Allow the lawn to dry
	Blade is blunt or damaged	Replace or sharpen the blade
	Vent is blocked	Clean the vents on the grass catcher
Wheel drive does not function	V-belt / gears damaged	Check the V-belt / gears
	Wheels damaged	Check the drive wheels for damage
Machine leaves ragged finish	Height of cut is too low	Increase the height of cut
	Blade is blunt or damaged	Replace or sharpen the blade

⚠ Warning: Before performing any maintenance or cleaning work, always remove batteries and switch off the isolator key! Only when the blade is completely stopped.

⚠ CAUTION! Faults which cannot be rectified with the aid of this table must be rectified by your local Cobra dealer.

13. ENVIRONMENTALLY FRIENDLY DISPOSAL



According to EU directive 2012/19/EU on electric and electronic equipment and its implementation into national law, all electric tools must be separately collected and environmentally friendly recycled. Alternative disposal: If the owner of the power tool does not return the tool to the manufacturer, he is responsible for proper disposal at a designated collection point that prepares the device for recycling according to national recycling laws and regulations. This does not include accessories and tools without electric or electronic components.

14. Warranty

This product is warranted in accordance with legal regulations for a 24 month period effective from the date of purchase by the first user.

This product will not be covered if used in a commercial application.

This warranty covers all material or production failures, it does not include: defects from normal wear and tear, parts such as, bearings, brushes, cables, air cleaning elements, brake pad, clutch disc, tyre, wheel, recoil starter rope, belts, cutter blades, plugs, lubricant oils and grease or accessories. Damage or defects resulting from abuse, accidents or alterations, natural fading of painted or plated surfaces, sheet peeling and other natural deterioration.

Any damage that occurs from the use of non-genuine Cobra parts will not be covered.

We reserve the right to reject any claim where the purchase cannot be verified or when it is clear that the product was not maintained properly. (Clean ventilation slots, carbon brushes and serviced regularly)

Expenses incidental to the warranty claim that are not covered;

-Compensation for loss of time, commercial loss or rental costs of substitute product.

-Costs incurred for transportation to and from the dealership.

Any damage that occurs from the following will not be covered; exposure of the product to smoke and soot, chemical agents, bird droppings or other animal waste, seawater, sea breeze, salt or other environmental phenomena. Any damage resulting from operating methods other than those indicated in the owner's manual will not be covered.

Your purchase receipt must be kept as proof for date of purchase. Your un-dismantled mower must be returned to your dealer in an acceptably clean state, accompanied by your proof of purchase.

Please Register Your Mower

If your dealer did not collect registration information from you, please take a few minutes and register your purchase with Cobra. You can register by completing the online registration at: www.cobragarden.co.uk and clicking on Product Registration.

15. EC-DECLARATION OF CONFORMITY

EC Declaration of Conformity	
We herewith declare,	Cobra Garden Machinery Henton & Chattell Ltd, London Road, Nottingham NG2 3HW UK
That the following machine complies with the appropriate basic safety and health requirements of the EC Directive based on its design and type, as brought into circulation by us.	
In case of alteration of the machine, not agreed upon by us, this declaration will lose its validity	
Product	Cordless Lawn Mower
Machine Type:	MX51S80V (DYM192404)
Rated voltage:	80V dc
Measured sound power level:	88.5dB(A)
Guaranteed sound power level:	92dB(A) Notified Body for EC Directive 2000/14/EC:0359 Intertek Testing&Certification Ltd Davy Avenue, Knowlhill, Milton Keynes, Mk5 8NL
Applicable EC Directives:	2014/30/EU 2006/42/EC 2000/14/EC 2011/65/EU
Applicable Harmonized Standards:	EN 60335-1 EN 60335-2-77 EN 62233 EN 55014-1 EN 55014-2
Authorized Signature/Date/ Place:	 4/8/2020
Title of Signatory:	Managing Director
Name and address of the person authorised to compile the technical file	Cobra Garden Machinery Henton & Chattell Ltd, London Road, Nottingham NG2 3HW UK